

# ECLIPSE STANDARD INDUSTRIAL BURNERS SERIES "SIB"

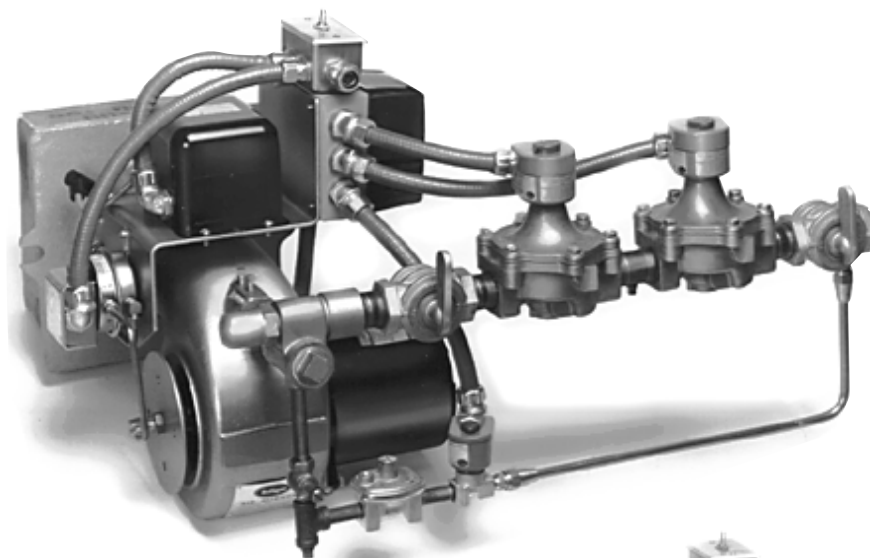

910 SIB-F

936 SIB-H

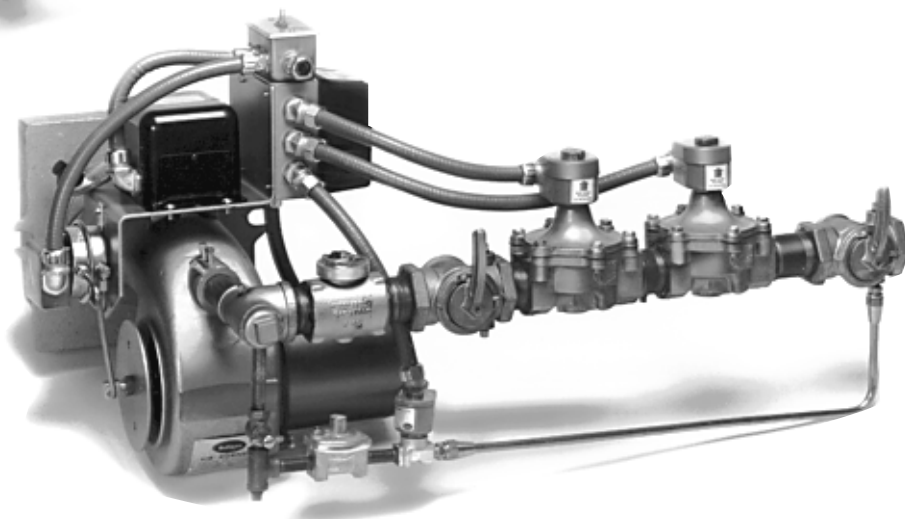

Eclipse Standard Industrial Burners (SIB) are easy to install, simple to operate, and offer long service life in industrial environments. They are pre-piped, wired, tested, and adjusted before shipment. It is necessary only to mount the burner and connect gas and electrical supplies to make the burner operational. To operate the burner, an operator need only turn the burner switch on or off as required.

SIB Burners are ideal for use in ovens, furnaces, kilns, or incinerators requiring simple burner operation and easy maintenance.

- Fully packaged, easy to install and operate.
- Rugged construction for long service life in industrial environments.
- Integral pilot and combustion air blower.
- Electronic flame monitoring.
- Two automatic gas shut-off valves per NFPA 86 recommendations.
- Air flow proving switch per NFPA 86 recommendations.
- 100% factory tested and adjusted.

**ECLIPSE COMBUSTION**

## Specifications

<b>Inputs</b>	<b>Burner</b>	<b>Motor</b>	<b>Btu/hr.</b>	<b>kW</b>	
Natural gas or propane vapor	910 SIB-F	1/8 hp	500,000	146.6	
	910 SIB-F	1/6 hp	800,000	234.5	
	936 SIB-G	1/6 hp	1,000,000	293.0	
	936 SIB-H	1/6 hp	1,400,000	410.3	
<b>Gas Inlet Pressures</b>	<b>Burner</b>	<b>Minimum</b>	<b>Maximum</b>		
At valve train inlet	910 SIB-F	4.0" w.c.	10.0 mbar	14.0" w.c.	34.8 mbar
	936 SIB-G	6.0" w.c.	14.9 mbar	14.0" w.c.	34.8 mbar
	936 SIB-H	4.7" w.c.	11.7 mbar	14.0" w.c.	34.8 mbar
<b>Electrical Supply</b>	120 VAC, 1 cycle, 60 Hz. 50 Hz available for 936 SIB-G & -H.				
<b>Motor Type</b>	TEFC with built-in thermal protection.				
<b>Firing Chamber Limits</b>	Draft required: 0.05" w.c. (0.13 mbar) minimum. SIB burners will not operate against any backpressure.				
<b>Ambient Temperature Limits</b>	-40° to +104°F (-40° to +40°C)				
<b>Materials</b>	Burner Body:	Cast aluminum			
	Blower Housing:	Cast aluminum			
	Impeller:	Steel			
	Block Holder:	Cast iron			
	Block:	Pre-fired high duty fireclay			
<b>Models</b>	<b>Burner</b>	<b>Assembly</b>	<b>Flame Monitor</b>	<b>Sensor</b>	<b>Sensor #</b>
	910 SIB-F	109913-00	None <sup>1</sup>	Flame rod	16946-2
	910 SIB-F	109913-33	Eclipse 5605-33	Flame rod	16946-2
	910 SIB-F	109913-01	Honeywell RA-890F	Flame rod	16946-2
	910 SIB-F	109913-32	Eclipse 5605-32	UV scanner	10939
	910 SIB-F	109913-02	Honeywell RA-890G	UV scanner	16281
	936 SIB-G	109914-00	None <sup>1</sup>	Flame rod	16946-2
	936 SIB-G	109914-33	Eclipse 5605-33	Flame rod	16946-2
	936 SIB-G	109914-01	Honeywell RA-890F	Flame rod	16946-2
	936 SIB-G	109914-32	Eclipse 5605-32	UV scanner	10939
	936 SIB-G	109914-02	Honeywell RA-890G	UV scanner	16281
	936 SIB-H	109915-00	None <sup>1</sup>	Flame rod	16946-2
	936 SIB-H	109915-33	Eclipse 5605-33	Flame rod	16946-2
	936 SIB-H	109915-01	Honeywell RA-890F	Flame rod	16946-2
	936 SIB-H	109915-32	Eclipse 5605-32	UV scanner	10939
	936 SIB-H	109915-02	Honeywell RA-890G	UV scanner	16281

<sup>1</sup> Burners ordered less relay include a flame rod, ignition plug, ignition transformer, and ignition cable. The customer must supply and install a suitable flame monitoring relay and base meeting local and/or insurance requirements.

**Flame monitoring equipment supplied with these burners by Eclipse may or may not meet local safety and/or insurance requirements. The owner/user and/or his insurance underwriter must assume responsibility for the acceptance, use, and proper maintenance of flame supervision, limit controls, and other safety devices.**

## Components

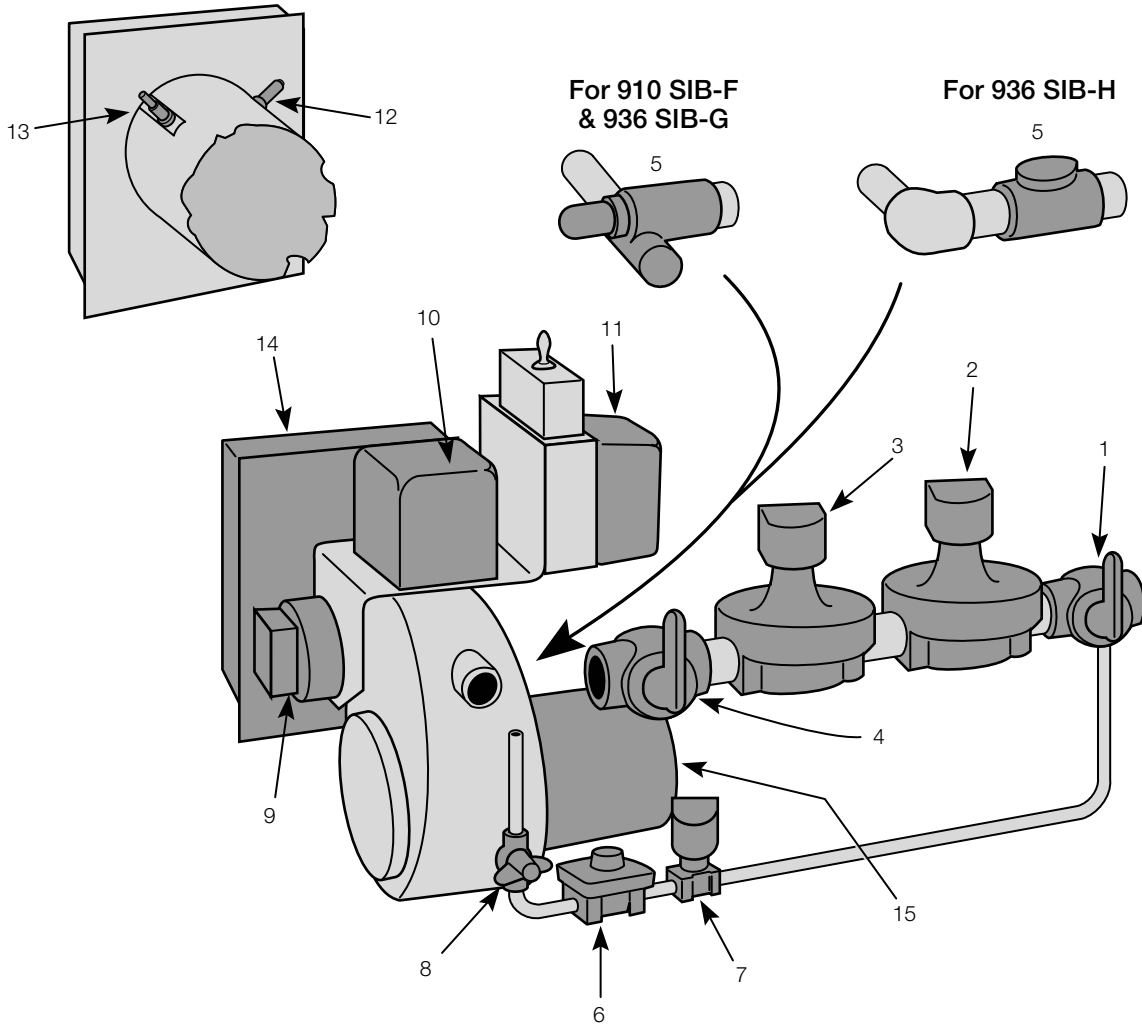

Item	Function	Description	910 SIB-F	936 SIB-G	936 SIB-H
1	Manual Gas Cock	---	19122	14916	14918
2	Automatic Gas Shut-Off	Eclipse Solenoid	13250	16728-9	16728-10
3	Automatic Gas Shut-Off	Eclipse Solenoid	13250	16728-9	16728-10
4	Manual Gas Cock	---	19122	14916	14918
5	Gas Adjusting Valve	Eclipse ALO-R Valve Eclipse Butterfly Valve	302040 ---	302041 ---	--- 500982
6	Pilot Regulator	RV 35A	15027	15027	15027
7	Automatic Pilot Valve	Eclipse Solenoid	16728-1	16728-1	16728-1
8	Adjustable Pilot Cock	---	12659	12659	12659
9	Air Flow Switch	SMDF-12C133	14494	14494	14494
10	Ignition Transformer Burner w/RA-890G All other burners	1/2/Wave Transformer 612-6A020E	13551 12178	13551 12178	13551 12178
11	Flame Monitor	See model under "Specifications."			
12	Flame Sensor	See model under "Specifications."			
13	Spark Plug	---	16946-1	16946-1	16946-1
14	Block & Holder	---	180149	180149	180149
15	Blower Motor	See Electrical Specs	16055*	12995	12995

\*Standard 1/8 hp. Optional 1/6 hp motor is #12995.

## Dimensions

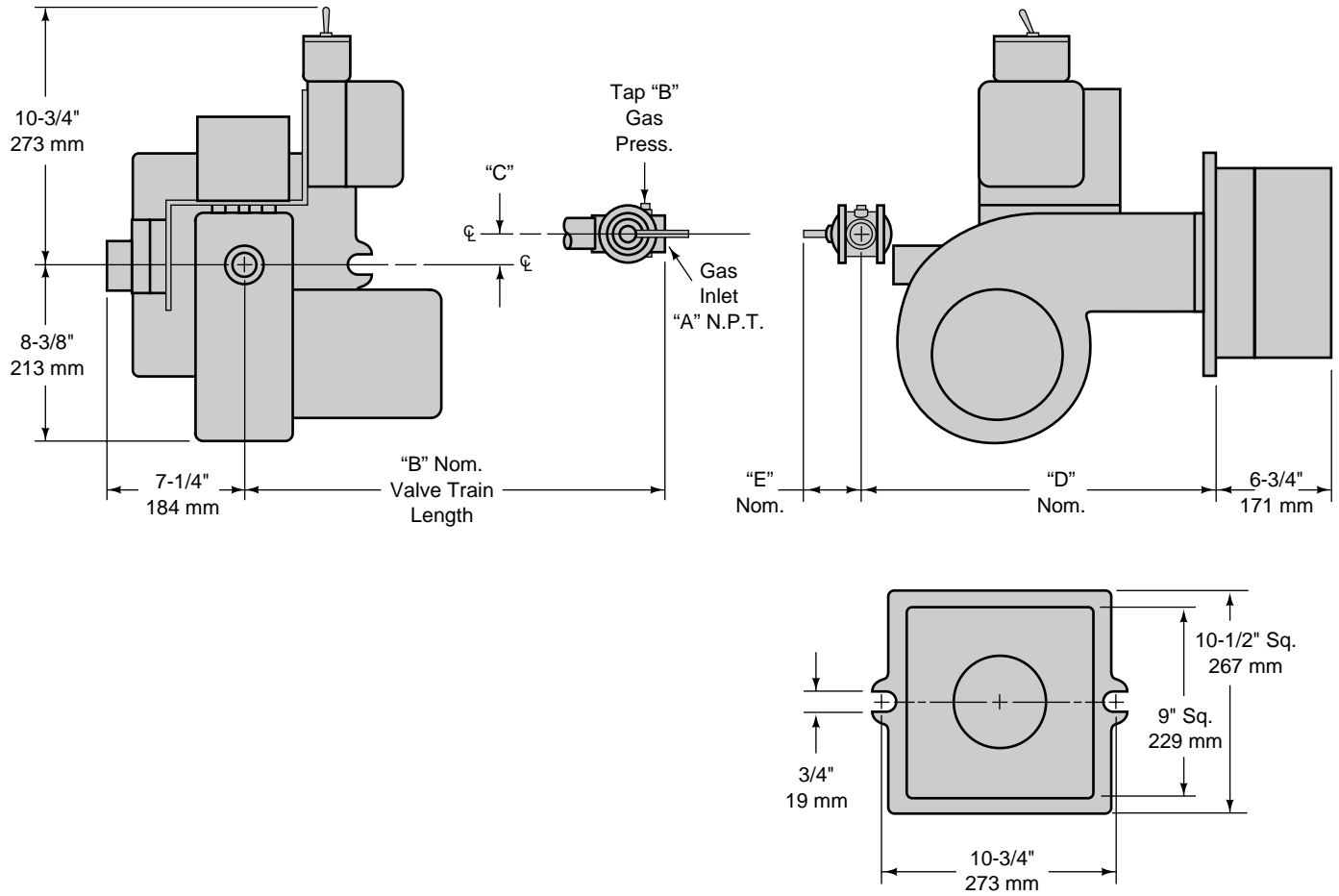

Burner	Dimensions						Net Wt.
	Units	A	B	C	D	E	
910 SIB-F	Inches	1	21	1-1/4	17-1/2	2-1/2	105 lb
	mm	---	533	32	445	64	47 kg
936 SIB-G	Inches	1-1/4	25-1/4	1-1/4	17-1/2	3	109 lb
	mm	---	641	32	445	76	49 kg
936 SIB-H	Inches	1-1/2	27-1/2	0	18	3-1/2	115 lb
	mm	---	699	0	457	89	52 kg



**ECLIPSE COMBUSTION**